

Theatre Passe Muraille

16 RYERSON AVE TORONTO, ONTARIO M5T 2P3 P 416.504.7529 F 416.504.8980 E INFO@PASSEMURAILLE.ON.CA W PASSEMURAILLE.CA

Andy McKim ARTISTIC DIRECTOR | Régine Cadet GENERAL MANAGER

TPM

Address & Telephone

Mainspace and Backspace Theatres:

16 Ryerson Avenue
Toronto, Ontario
M5T 2P3

Phone: 416.504.7529
Fax 416.504.8980

Office: (just around the corner)
54 Wolseley St,
Toronto, Ontario
M5T 1A5

Phone: 416.504.8988
Fax: 416.504.8980

Rental Procedure

Please note that Theatre Passe Muraille works based on a full production design style, rather than Road House style.

This means that when you rent the space, you start with the lighting and masking in storage. It is expected that you / your designers will provide us with your lighting design / stage design in advance, and on the FIRST day of your rental dates, the lighting design / stage design will be installed.

To rent the space, please fill out the form at:
<http://passemuraille.ca/archives/rentals/mainspace>

Once the conversation about rental dates starts, we may send you a tech questionnaire to fill out and return before the rental can be confirmed.

Theatre Passe Muraille

16 RYERSON AVE TORONTO, ONTARIO M5T 2P3 P 416.504.7529 F 416.504.8980 E INFO@PASSEMURAILLE.ON.CA W PASSEMURAILLE.CA

Andy McKim ARTISTIC DIRECTOR | Régine Cadet GENERAL MANAGER

What your Rental Includes

The contract goes into great detail, but essentially your rental fee for each week *includes:*

- 40 hours of our house technician time,
- all FOH & Box Office staff and costs if you stay within TPM's regular mainstage performance schedule: Wed-Sat @ 7:30pm & a Saturday Matinee @ 2:00 p.m.
- Web, phone & in person sale of your tickets.

What is not included:

- Load in/Lighting Hang/Strike labour fees for the technicians beyond the house tech
- Insurance (we can provide you with forms to apply for 3rd party insurance through our insurer, or you can find another company)
- Any house technician time over the 40 hours per week.
- Any FOH / Box Office staffing charges for bringing in staff for performances outside of TPM's schedule.
- (Note: we do not have a house lighting plot already hung for rental use – this must be accommodated for in design and in hang/focus time by the rental company)

As mentioned above, it is important to note that your rental does not come with lights in the air ready to be focused. There are no stage lights plugged in or hung at the beginning of a rental and we hang the lights specific to each company's design plot. The common practice is for the rental company to hire a designer to prep, plan, and draft a lighting plot, which we will hire crew to hang on your behalf.

If you don't want to hire a designer, there are several plots than can be rented. Please contact us for information. NOTE: you still need to budget the time and money for the labour to hang and focus the plots and to build any cues needed. The director, or someone else will still need to decide the looks of each cue.

For Festival shows:

Please note that if you are involved in a festival (ie Fringe / Summerworks etc) you will likely often do not have access to the full equipment stock. Please go through your festival to find out what is included for your show.

Rentals Coordinators

Eric Read – Production & Facility Manager ext 2138

Jenn Sartor – Producer ext: 2127

Theatre Passe Muraille

16 RYERSON AVE TORONTO, ONTARIO M5T 2P3 P 416.504.7529 F 416.504.8980 E INFO@PASSEMURAILLE.ON.CA W PASSEMURAILLE.CA

Andy McKim ARTISTIC DIRECTOR | Régine Cadet GENERAL MANAGER

Mainspace

Capacities

199 Persons – This includes the venue staff, show staff **and** performers.

185 Persons – Mainspace Audience Capacity:

If one level is not being used:

Mainfloor – 134 (Upper floor is closed. Standing seating. Requires removal of seats. The stage is not licensed.)

Mezzanine Level – 132 (When the main floor is closed.)

NOTE the stages and the balcony US of the stage ARE NOT licensed.

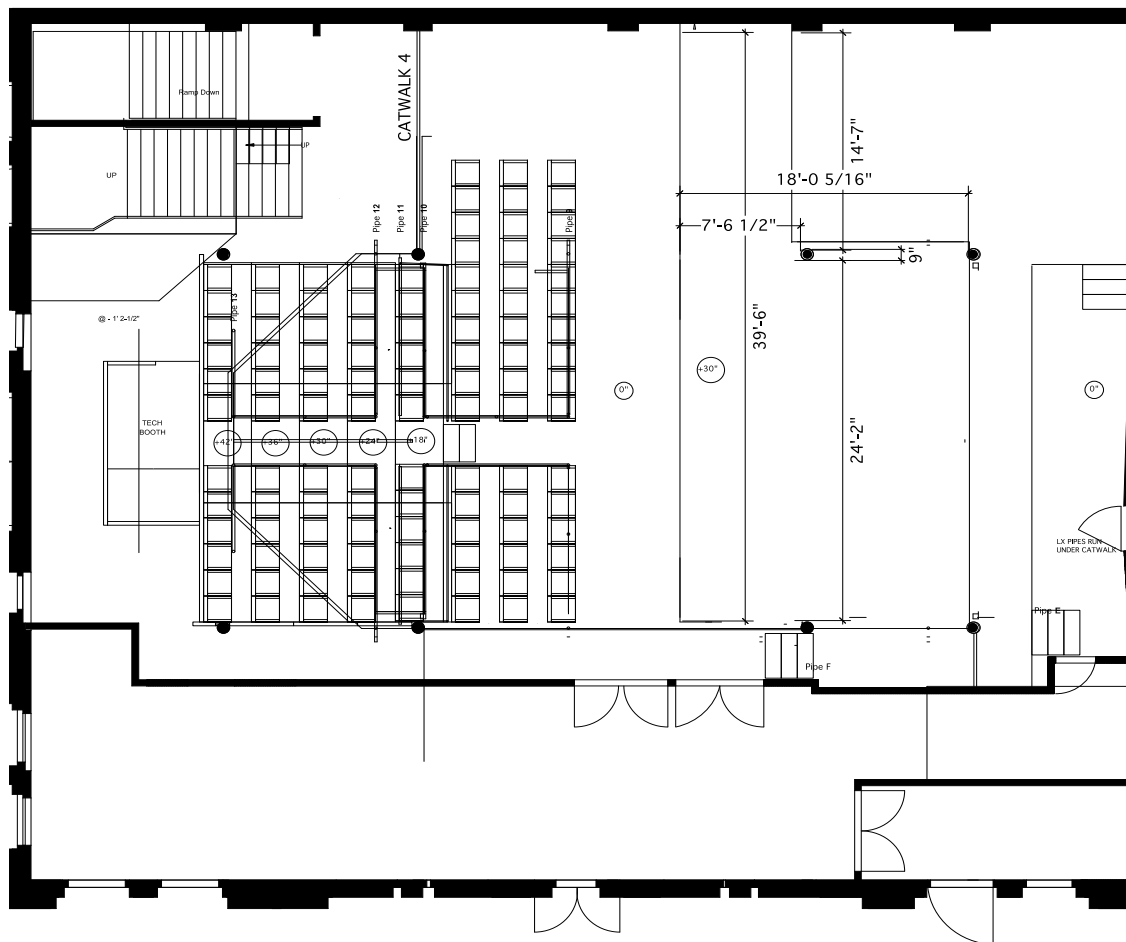

Deck

The drawing below includes the stage addition. (6' most DS area)

Theatre Passe Muraille

16 RYERSON AVE TORONTO, ONTARIO M5T 2P3 P 416.504.7529 F 416.504.8980 E INFO@PASSEMURAILLE.ON.CA W PASSEMURAILLE.CA

Andy McKim ARTISTIC DIRECTOR | Régine Cadet GENERAL MANAGER

Dimensions

Depth - between 22' and 28'3"

Width - 40'1"

Stage Lip to Projector position (off balcony rail ctr) - ~29'

Deck Height - 30-31" (auditorium floor is unlevel)

Clearance under Mezzanine USR, US, and SL - 8'6"

Grid Height -

Under pipe - 19'1"

Knee Rail - 21'4"

High Rail - 23'

Surround Pipes (the majority are close to the under pipe height. Contact for details)

Related equipment

Upright Piano on 2nd floor, near cab stage. We do not keep it in regular tune, so inquire as to its state.

Masking (please confirm in advance)

2 - 26'wx22'h panel with webbed and grommetted top, pocketed bottom.

4 - 15'w x 9'2" h panel with webbed and grommetted top

2 - 12'w x 19'h panel with webbed and grommetted top, pocketed bottom (poor shape)

1 - 13'4w x 11'6" high (extremely poor shape)

1 - 24'6" w x 4'10" high border. (decent shape)

1 - 11'5w x 22'10"high (decent shape)

1 - 20'w x 12'high canvas drop. With webbed and grommetted top, pocketed bottom

Shared Inventory Note:

With all shared inventory, please check for availability in advance. Note there may be an additional cost for shared inventory.

Theatre Passe Muraille

16 RYERSON AVE TORONTO, ONTARIO M5T 2P3 P 416.504.7529 F 416.504.8980 E INFO@PASSEMURAILLE.ON.CA W PASSEMURAILLE.CA

Andy McKim ARTISTIC DIRECTOR | Régine Cadet GENERAL MANAGER

Lighting

Control System

ETC ION 1000 Control Console

Console Accessories

24 Channel Ion Submaster Wing

Circuits

New Style Twist home runs from each overhead catwalk, + 10 circuits dropped to deck level.

Dimming

95 dimmer ETC Sensor rack @ 1.2K

Aux / Tie in Power

None available

Instrument Inventory

Fixture Type	Current	Lensing	Degree options	In Stock	Notes
Source-4 ERS - 750W	HPL-750	Interchangeable barrels	19, 26, 36, 50, 90 degrees	72	Note: We have one less fixture than lens tubes.
19 Degree Barrels				15	
26 Degree Barrels				20	
36 Degree Barrels				25	
50 Degree Barrels				10	
90 Degree Barrels				2	
Strand 6" Fresnelite	BTR	Stepped	8-59 Degree	16	
Capital Lighting 6" Fresnel	BTN	Stepped	13-65 Degree	18	
PAR 64	Wide	Per Bulb	Per Bulb	18	Currently all lamped wide

Theatre Passe Muraille

16 RYERSON AVE TORONTO, ONTARIO M5T 2P3 P 416.504.7529 F 416.504.8980 E INFO@PASSEMURAILLE.ON.CA W PASSEMURAILLE.CA

Andy McKim ARTISTIC DIRECTOR | Régine Cadet GENERAL MANAGER

SHARED Lighting Accessories – Check on availability

7.5 " Barn Doors	
2" Snoot	42
1" Snoot	3
No Snoot	12

Source-4 Irises	8
-----------------	---

10" Barn Doors	
No Snoot	10

Top Hats	
6.25"	9

Automation (Extra cost for use, Shared Inventory)

- 2 - Rosco I-Cue moving Mirror
- 4 - Seachanger Tungsten for Source 4
- 1 - Auto-iris

Theatre Passe Muraille

16 RYERSON AVE TORONTO, ONTARIO M5T 2P3 P 416.504.7529 F 416.504.8980 E INFO@PASSEMURAILLE.ON.CA W PASSEMURAILLE.CA

Andy McKim ARTISTIC DIRECTOR | Régine Cadet GENERAL MANAGER

Sound

Consoles

Behringer X32 Digital

Console Accessories

Ipad 2 with Behringer remote software

Routing

Behringer X32 USB interface

Playback

Qlab3 (Check for availability and cost)

Microphones

1x Shure VP89L house program microphone (reserved for accessibility)

1x Williams Sound MIC 054 (for use with hearing assist AD system)

Speakers

2 x EV Sx100 (Our standard mains)

1 x Yorkville YSL Elite 15" 700W powered sub

Amplifiers

TOA P1500 stereo amplifier

Yorkville Audiopro 3000 stereo amplifier

QSC USA900 stereo amplifier

Snake

16 CH XLR with 3 XLR return

Theatre Passe Muraille

16 RYERSON AVE TORONTO, ONTARIO M5T 2P3 P 416.504.7529 F 416.504.8980 E INFO@PASSEMURAILLE.ON.CA W PASSEMURAILLE.CA

Andy McKim ARTISTIC DIRECTOR | Régine Cadet GENERAL MANAGER

Shared Sound Inventory

Mic Stands	-
Tripod Boom Stand	3
Bell Base Boom Stand	3
Straight Bell Base Stand	4
Short Table Mic Stand	1?

Microphones	
Shure SM57	4
Shure SM58	2
Shure C606	2
Shure RS25	3
Audix ADX40 Cardioid Hanging	3

Dis	
Zdirect Passive Mono	2
Radial Passive Mono	1
Art Passive Dual	1

Music Stands	-
Stageline Adjustable Tripod	2
Manhasset Set Tripod	4

Music Stand Lights	
Epic Non-Dimmable	4

Communications

Intercom

CS-222 Base Station
4 headsets and beltpacks.

Theatre Passe Muraille

16 RYERSON AVE TORONTO, ONTARIO M5T 2P3 P 416.504.7529 F 416.504.8980 E INFO@PASSEMURAILLE.ON.CA W PASSEMURAILLE.CA

Andy McKim ARTISTIC DIRECTOR | Régine Cadet GENERAL MANAGER

Projections

Shared Projectors (Extra cost for use)

Panasonic PT-DZ530U

Epson ProG6150NL

1x 6'x8' pull down screen

1x 10'x12' fast fold without the black masking kit.

Shop, Rehearsal & Loading

Cabaret stage

A bar and Cabaret space are available for events during your run. Please see our website for details.

Shop

Shop space (no spray booth or spray painting) is available for a reasonable \$100 + \$5 fasteners fee /day rate. If you wish to use your own carpenter, please contact us in advance. We reserve the right to insist upon the use of one of our carpenters. (\$22.45/hr base rate)

All carpenters must show proof of WSIB or be employed as TPM staff.

Please see our website or contact us for more details.

Rehearsal

We do not have any rehearsal space. The theatre may be rented as a rehearsal hall.

Loading

There is no raised loading at TPM. Loading is generally done through our Wolseley st door which is 44" x 99 1/2" Note there is a step and a slight ramp inside the space.