

Theatre Passe Muraille

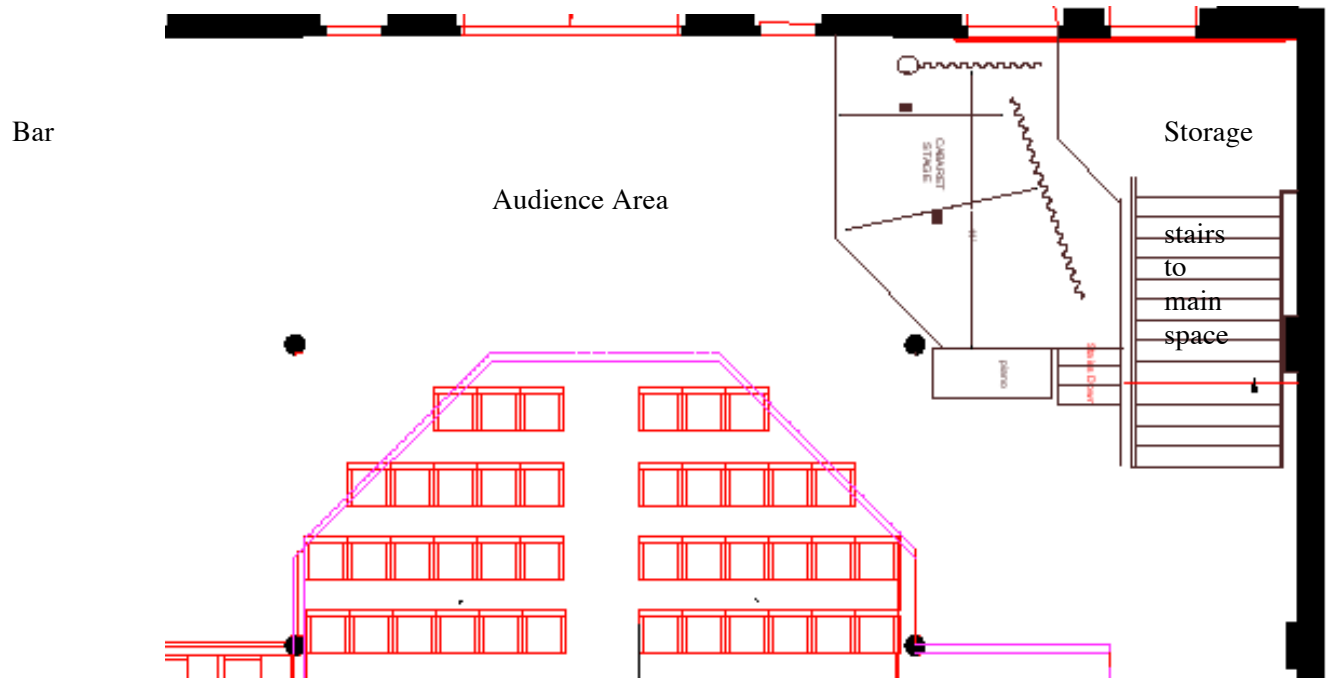

Masking

Upstage and Stage Right masking

Lighting

Lighting cannot be refocused

2x6 manual lx board : 6 channels

15a power available, however be aware this is the same 15amp circuit as used for PA and onstage gear.

Sound

Console: Yamaha MX 12/4

Accessories: Behringre 16 band stereo EQ (set for room EQ. Non-modifiable)

Mixes

Main Mix through 2x 12" Yorkville 10" fuzzy boxes.

1 monitor mix available as aux from console. No speakers available

Playback

1/8" jack for ipod / computer

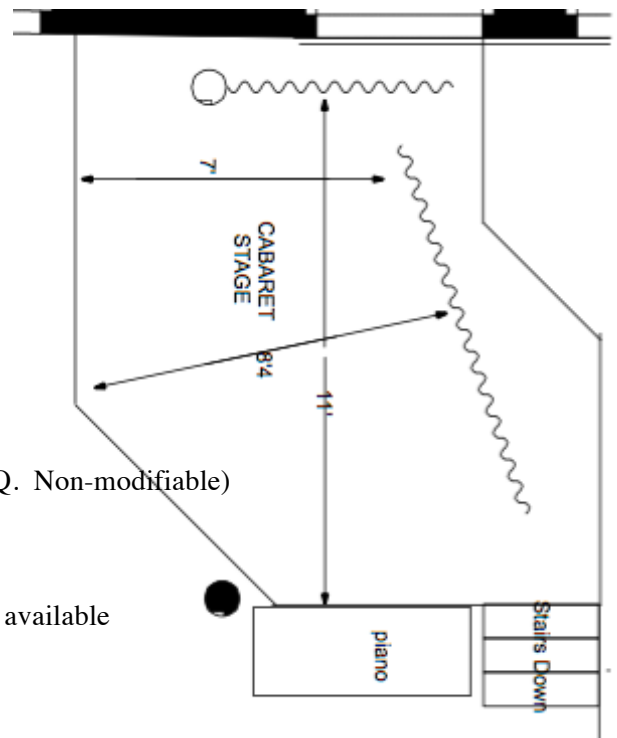

Microphones (Shared, check for availability)

<u>Mic Stands</u>	-
Tripod Boom Stand	3
Bell Base Boom Stand	3
Straight Bell Base Stand	4
Short Table Mic Stand	1?

<u>Microphones</u>	
Shure SM57	4
Shure SM58	2
Shure C606	2
Shure RS25	3
Audix ADX40 Cardioid Hanging	3

<u>Dis</u>	
Zdirect Passive Mono	2
Radial Passive Mono	1
Art Passive Dual	1

<u>Music Stands</u>	-
Stageline Adjustable Tripod	2
Manhasset Set Tripod	4

<u>Music Stand Lights</u>	
Epic Non-Dimmable	4

Communications and Projections

Intercom None available

Projector (Additional cost, check for availability)

Panasonic ptdw 530u projector with standard lens

Epson ProG6150NL with standard lens

Green Room Green room and Dressing Room space not available

Shop, Rehearsal & Loading Shop and Rehearsal space not available. Load in through Main Theatre Entrance. Note: stairs required to access the venue.