

theatre passe muraille

mainspace theatre tech package

Address & Telephone

Mainspace and Backspace Theatres:

16 Ryerson Avenue
Toronto, Ontario
M5T 2P3

Phone: 416-504-7529

Fax: 416-504-8980

Office:

555 Richmond St. W.
Suite 502
Toronto, Ontario
M5V 3B1

Phone: 416-504-8988

Fax: 416-504-8980

Rental Procedure

Please note that Theatre Passe Muraille works based on a full production design style, rather than Road House style.

This means that when you rent the space, you start with the lighting and masking in storage. It is expected that you / your designers will provide us with your lighting design / stage design in advance, and on the FIRST day of your rental dates, the lighting design / stage design will be installed.

To rent the space, please fill out the form at:

<https://www.passemuraille.ca/venue-rental/mainspace-theatre/>

Once the conversation about rental dates starts, we may send you a tech questionnaire to fill out and return before the rental can be confirmed.

What your Rental Includes

The contract goes into great detail, but essentially your rental fee for each week

includes:

- 40 hours of our house technician time,
- all FOH & Box Office staff and costs if you stay within TPM's regular mainstage performance schedule: Wed-Sat @ 7:30pm & a Saturday Matinee @ 2:00 p.m.
- Web, phone & in person sale of your tickets.

What is not included:

- Load in/Lighting Hang/Strike labour fees for the technicians beyond the house tech
- Insurance (we can provide you with forms to apply for 3rd party insurance through our insurer, or you can find another company)
- Any house technician time over the 40 hours per week.
- Any FOH / Box Office staffing charges for bringing in staff for performances outside of TPM's schedule.

*(NOTE: we do not have a house lighting plot already hung for rental use – this must be accommodated for in design and in hang/focus time by the rental company)

As mentioned above, it is important to note that your rental does not come with lights in the air ready to be focused. There are no stage lights plugged in or hung at the beginning of a rental and we hang the lights specific to each company's design plot. The common practice is for the rental company to hire a designer to prep, plan, and draft a lighting plot, which we will hire crew to hang on your behalf.

If you don't want to hire a designer, there are several plots that can be rented. Please contact us for information.

*NOTE: you still need to budget the time and money for the labour to hang and focus the plots and to build any cues needed. The director, or someone else, will still need to decide the looks of each cue.

For Festival shows:

Please note that if you are involved in a festival (ie Fringe / Summerworks etc) you will likely not have access to the full equipment stock. Please go through your festival administrators to find out what is included for your show.

Rental Coordinators

Eric Read – Production & Facility Manager ext. 2138

Jenn Sartor – Producer ext: 2127

Mainspace Capacities

199 Persons – This includes the venue staff, show staff **and** performers.

185 Persons – Mainspace Audience Capacity:

- If one level is not being used:
 - Mainfloor – 134 (Upper floor is closed. Standing seating. Requires removal of seats. The stage is not licensed.)
 - Mezzanine Level – 132 (When the main floor is closed.)

NOTE: the stages and the balcony US of the stage ARE NOT licensed.

Deck

The drawing below includes the stage addition. (6' most DS area)

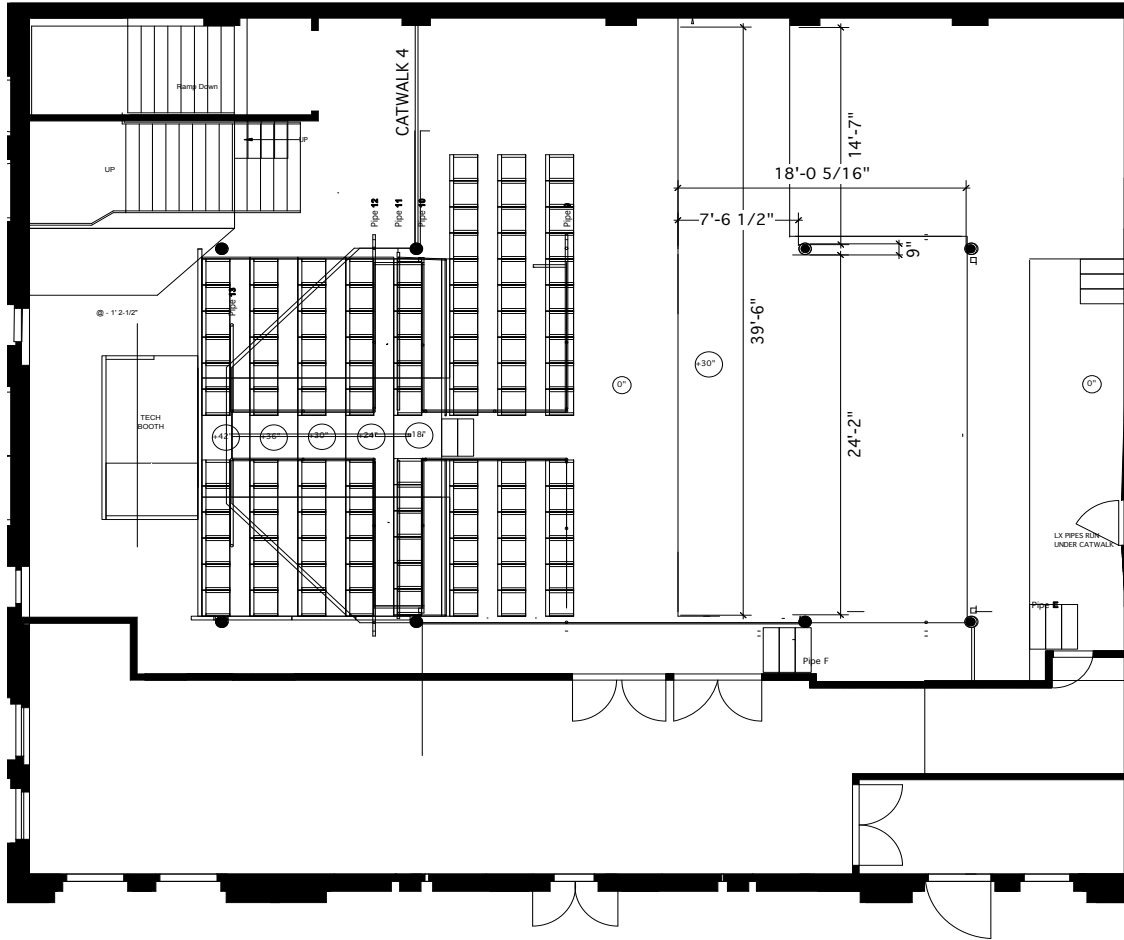

Dimensions

Depth: between 22' and 28'3"

Width: 40'1"

Stage Lip to Projector position (off balcony rail ctr): ~29'

Deck Height: 30-31" (auditorium floor is unlevel)

Clearance under Mezzanine USR, US, and SL: 8'6"

Grid Height:

Under pipe - 19'1"

Knee Rail - 21'4"

High Rail - 23'

Surround Pipes (the majority are close to the under-pipe height. Contact for details)

Related equipment

Upright Piano on 2nd floor, near cab stage. We do not keep it in regular tune, so inquire as to its state.

Masking (please confirm in advance)

- 2 - 26'w x 22'h panel | webbed and grommetted top, pocketed bottom
- 4 - 15'w x 9'2" h panel | webbed and grommetted top
- 2 - 12'w x 19'h panel | webbed and grommetted top, pocketed bottom (poor shape)
- 1 - 13'4w x 11'6" high (poor shape)
- 1 - 24'6" w x 4'10" high border (decent shape)
- 1 - 11'5w x 22'10" high (decent shape)
- 1 - 20'w x 12' high canvas drop | webbed and grommetted top, pocketed bottom

Shared Inventory Note:

With all shared inventory, please check for availability in advance.

NOTE: there may be an additional cost for shared inventory.

Lighting

Control System	Console Accessories	Circuits
ETC ION 1000 Control Console	24 Channel Ion Submaster Wing	New Style Twist home runs from each overhead catwalk, + 10 circuits dropped to deck level.
Dimming	Aux / Tie in Power	
95 dimmer ETC Sensor rack @ 1.2K	None available	

Instrument Inventory:

Fixture Type	Current	Lensing	Degree options	In Stock	Notes
Source-4 ERS - 750W	HPL-750	Interchangeable barrels	19, 26, 36, 50, 90 degrees	72	Note: We have one less fixture than lens tubes.
19 Degree Barrels				15	
26 Degree Barrels				20	
36 Degree Barrels				25	
50 Degree Barrels				10	
90 Degree Barrels				2	
Strand 6" Fresnelite	BTR	Stepped	8-59 Degree	16	
Capital Lighting 6" Fresnel	BTN	Stepped	13-65 Degree	18	
PAR 64	Wide	Per Bulb	Per Bulb	18	Currently all lamped wide

SHARED Lighting Accessories

Check on availability

7.5 " Barn Doors	
2" Snoot	42
1" Snoot	3
No Snoot	12

Source-4 Irises	8
-----------------	---

10" Barn Doors	
No Snoot	10

Top Hats	
6.25"	9

Automation (Extra cost for use, Shared Inventory)

- 2 - Rosco I-Cue moving Mirror
- 4 - Seachanger Tungsten for Source 4
- 1 - Auto-iris

Sound

Consoles	Console Accessories	Routing
Behringer X32 Digital	Ipad 2 with Behringer remote software	Behringer X32 USB interface
Playback	Amplifiers	Snake
Qlab3 (Check for availability and cost)	TOA P1500 stereo amplifier Yorkville Audiopro 3000 stereo amplifier QSC USA900 stereo amplifier	16 CH XLR with 3 XLR return
Speakers	Microphones	
2 x Yorkville Parasource PS15P (Our standard mains) 1 x Yorkville YSL Elite 15” 700W powered sub	1x Shure VP89L house program microphone (reserved for accessibility) 1x Williams Sound MIC 054 (for use with hearing assist AD system) 1x SM58 Wireless handheld microphone (Check for availability)	

Shared Sound Inventory:

Mic Stands		Music Stands		Dis	
Tripod Boom Stand	3	Stageline Adjustable Tripod	2	Zdirect Passive Mono	2
Bell Base Boom Stand	3	Manhasset Set Tripod	4	Radial Passive Mono	1
Straight Bell Base Stand	4			Art Passive Dual	1
Short Table Mic Stand	1?	Music Stand Lights			
		Epic Non-Dimmable	4		
Microphones					
Shure SM57	4	Speakers			
Audix ADX40 Cardioid Hanging	3	Yorkville C170P Powered speaker	11		
Shure C606	2				
Shure RS25	3				
Shure SM58	2				

Communications

Intercom

- CS-222 Base Station
- 4 headsets and beltpacks.
- DX410 wireless system with 4 beltpacks and 3 all-in-one headsets

Projections

Shared Projectors (Extra cost for use)

Panasonic PT-DZ530U

Epson ProG6150NL

1x 6'x8' pull down screen

1x 10'x12' fast fold without the black masking kit

Shop, Rehearsal & Loading

Cabaret stage

A bar and Cabaret space are available for events during your run. Please see our website for details.

Shop

We do not have any shop space. Some basic carpentry can be done onsite, but please confirm with TPM's Production Manager

Rehearsal

We do not have any rehearsal space. The theatre may be rented as a rehearsal hall.

Loading

There is no raised loading at TPM. Loading is generally done through our Wolseley st door which is 44" x 99 1/2". Note there is a ramp from the sidewalk and a slight ramp inside the space.