

theatre passe muraille

cabaret space technical overview

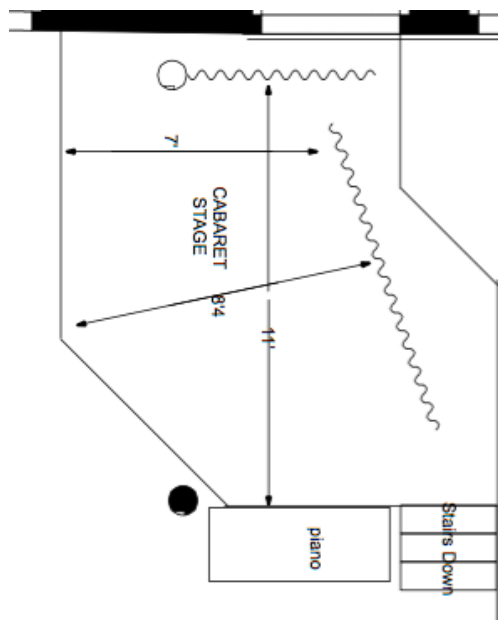
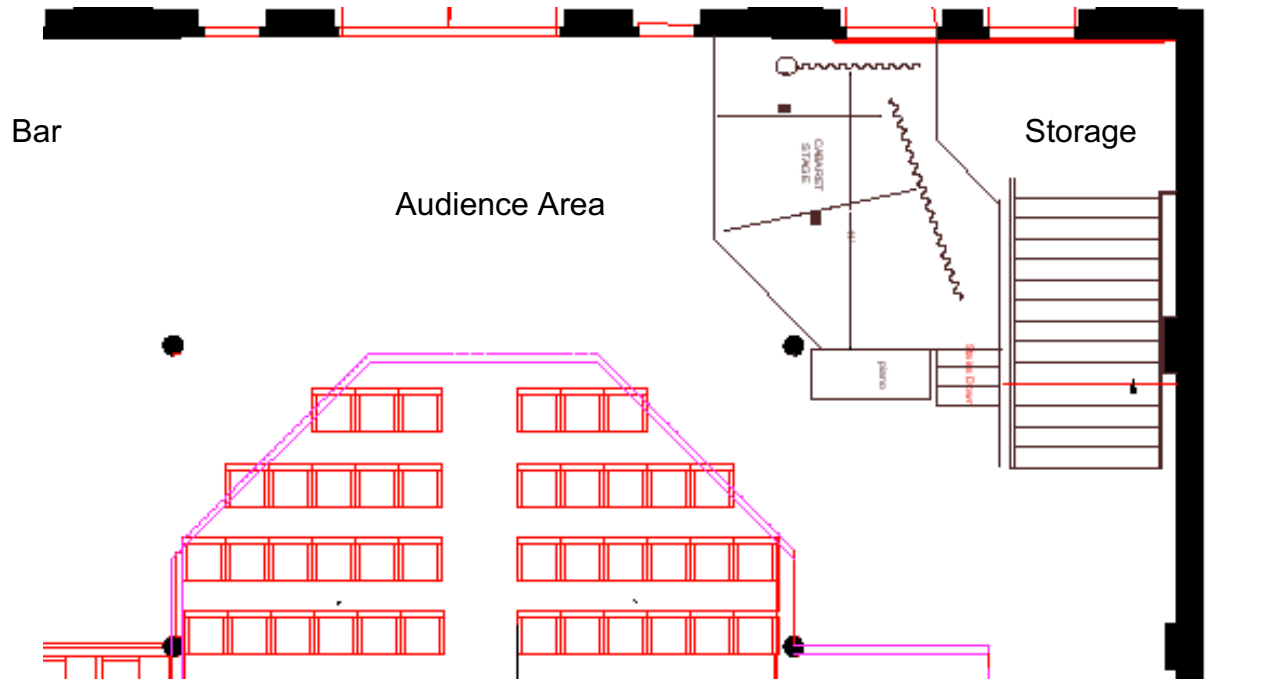

Masking

Upstage and Stage Right masking

Lighting

Lighting cannot be refocused
2x6 manual lx board : 6 channels
15a power available, however be aware this is the same 15amp circuit as used for PA and onstage gear.

Playback

1/8" jack for ipod / computer

Sound

Console: Yamaha MX 12/4
Accessories: Behringre 16 band stereo EQ (set for room EQ. Non-modifiable)

Mixes

Main Mix through 2x 12" Yorkvile 10" fuzzy boxes.
1 monitor mix available as aux from console. No speakers available

Microphones (Shared, check for availability)

Mic Stands		Dis	
Tripod Boom Stand	3	Zdirect Passive Mono	2
Bell Base Boom Stand	3	Radial Passive Mono	1
Straight Bell Base Stand	4	Art Passive Dual	1
Short Table Mic Stand	1?		
		Music Stands	
Microphones		Stageline Adjustable Tripod	2
Shure SM57	4	Manhasset Set Tripod	4
Shure SM58	2		
Shure C606	2	Music Stand Lights	
Shure RS25	3	Epic Non-Dimmable	4
Audix ADX40 Cardioid Hanging	3		

Communications and Projections

Intercom None available

Projector (Additional cost, check for availability)

Panasonic ptdw 530u projector with standard lens

Epson ProG6150NL with standard lens

Green Room

Green room and Dressing Room space not available

Shop, Rehearsal & Loading

Shop and Rehearsal space not available. Load in through Main Theatre Entrance.

***NOTE:** stairs required to access the venue.